



ACA PERMIT FINDER PHASE II

Updates to the Arizona Permit Finder

Phase II of Arizona's Permit Finder enables users to create custom project areas and view permit requirements with new features.

- **Upload Area:** To view permits and agencies within a specific area, add data and reference layers including Shapefile, CSV, KML, GeoJSON, GPX, or FGDB file.
- **Draw Area:** Create custom map layers for precise visualization.
- **Export Tools:** Export custom areas to review relevant agencies and permits.

For technical assistance support, please refer to the 'About' button in the top right corner of the tool.



Upload Area

1) Main Menu:

Select 'Upload Area' at the bottom of the left menu.

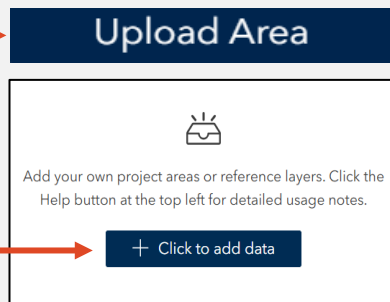

2) Add Data:

Click the blue button in the middle of the left menu to add Areas.

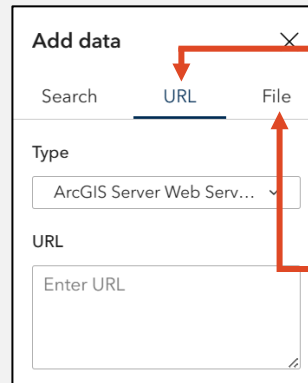

2a) URL: Click the 'URL' button to add a publicly accessible online layer.

2b) File: Click 'File' to upload a file.



Upload Area: Search Curated Layers Widget

3) Search:

Click the search bar to search and filter the list of curated layers to add to the map as a reference layer.

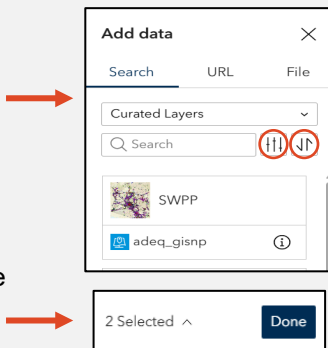

4) Select Layers:

Choose one or more layers and click Done to add them to the workspace.

5) Add to Map: Click the button with four dots to add the layer to the map.

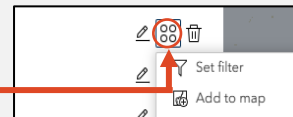

6) Set Location: Send results of uploaded area to the Agencies or Permits panel to analyze all features in new layer.

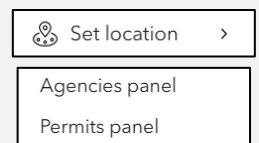

*Refer to **Step 3a) Export Results** below for export information.*



Draw Area

1) Main Menu:

Use the left menu to select 'Draw Area'.



2) Create a Drawing:

Click the point (left), line (center), or polygon (right) option to begin drawing a shape.

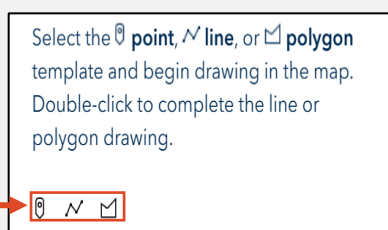

3) Manage Drawing:

Click the three icons to export results, clear drawing, and refresh results.



3a) Export Results: Once agency and permit results are populated on the right panel, results within the drawn area can be exported into a PDF or CSV report.

